



SILENT TRAC

by ***CURRENT***

Zigbee Setup with the Bridge (no App)



1A. Power Bridge

- Find an outlet location
- Insert the micro-usb end of the included power cable into the power port on the bridge
- Plug the other end of the cable into an outlet
- Make sure the bridge is installed or placed 2ft above the ground

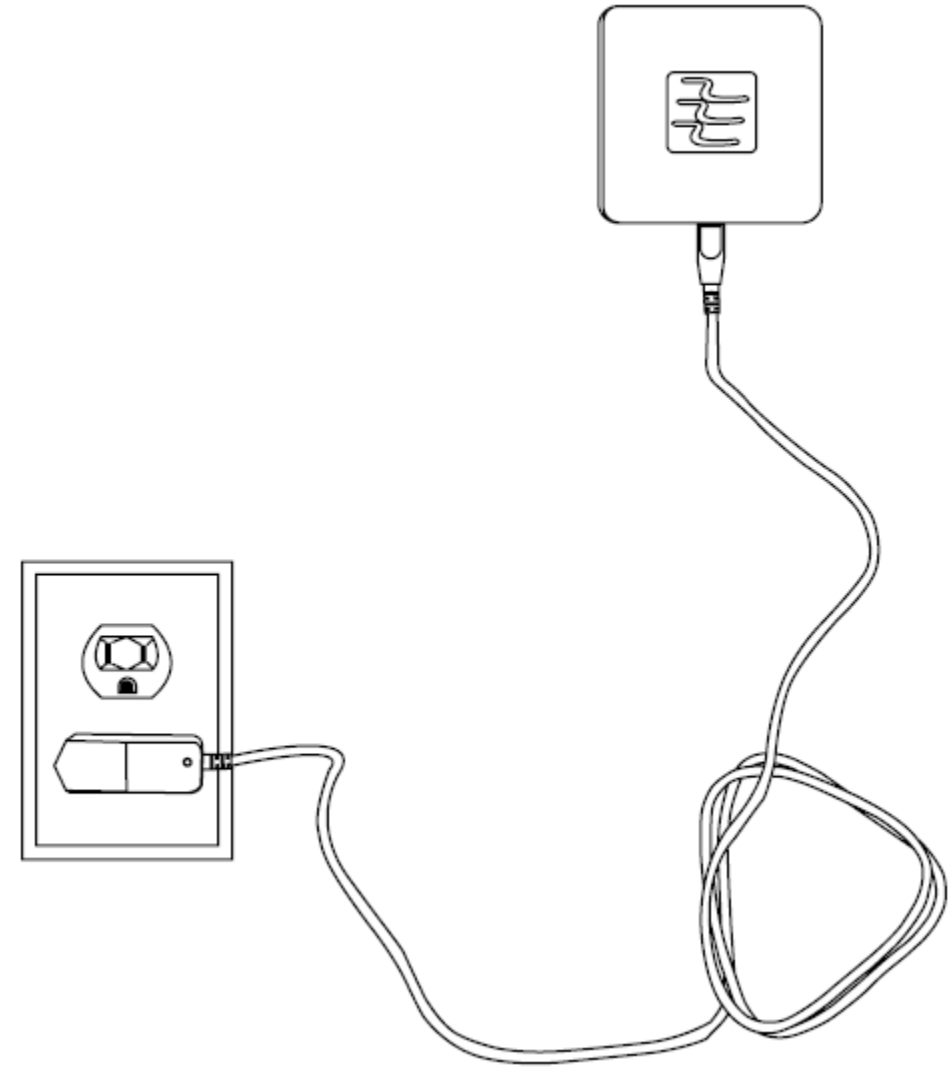

1B. Power Bridge

- The LEDs on the bottom of the bridge will be solid red and green during startup
- The LEDs will then turn solid red



Solid Blue
Bluetooth Enabled



Flashing Blue
Join Mode



Solid Green
Connected to Server



Flashing Green
Command Received



Solid Red
No Internet



Flashing Red
Not Registered/Error

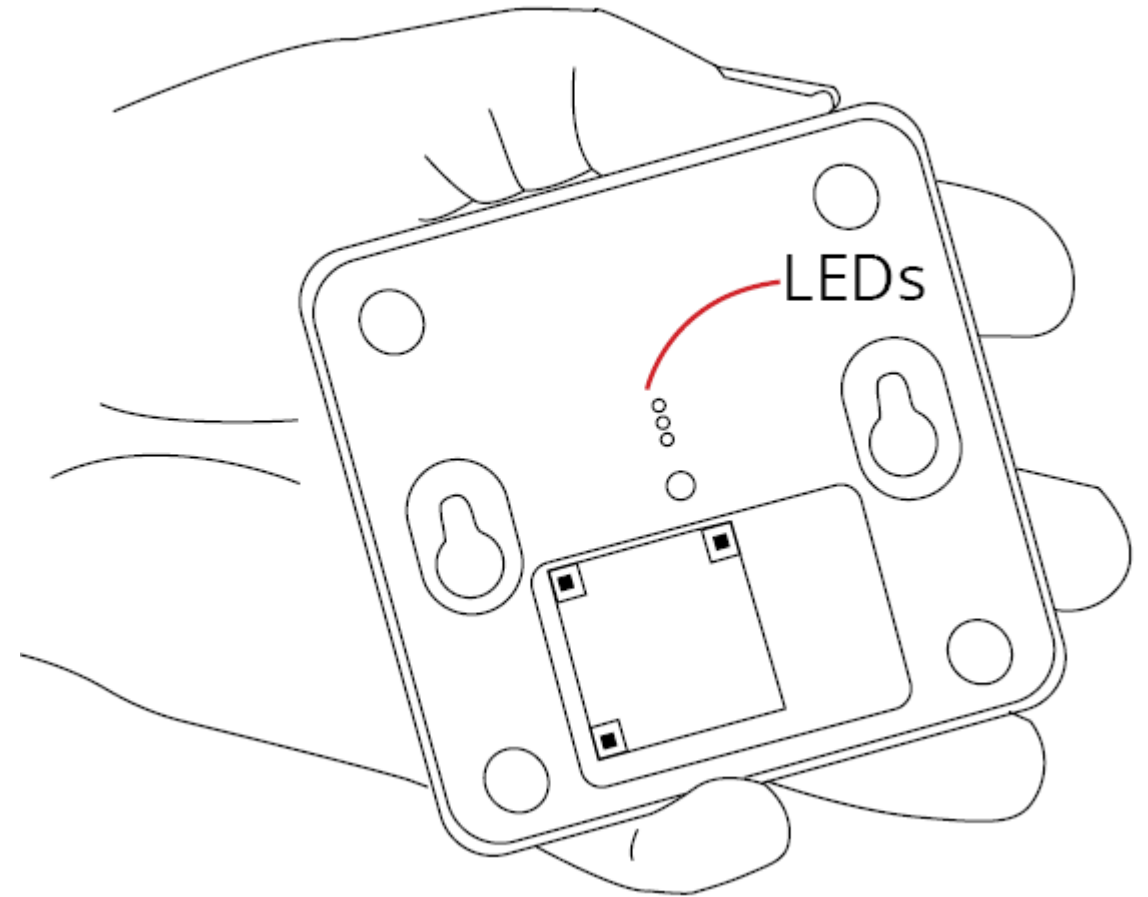

2. Put bridge in pairing mode

- Push a tack or paperclip into the hole in the back of the bridge
- Press and hold the recessed button for 5 seconds or until the LED begins to flash blue
- Release the button

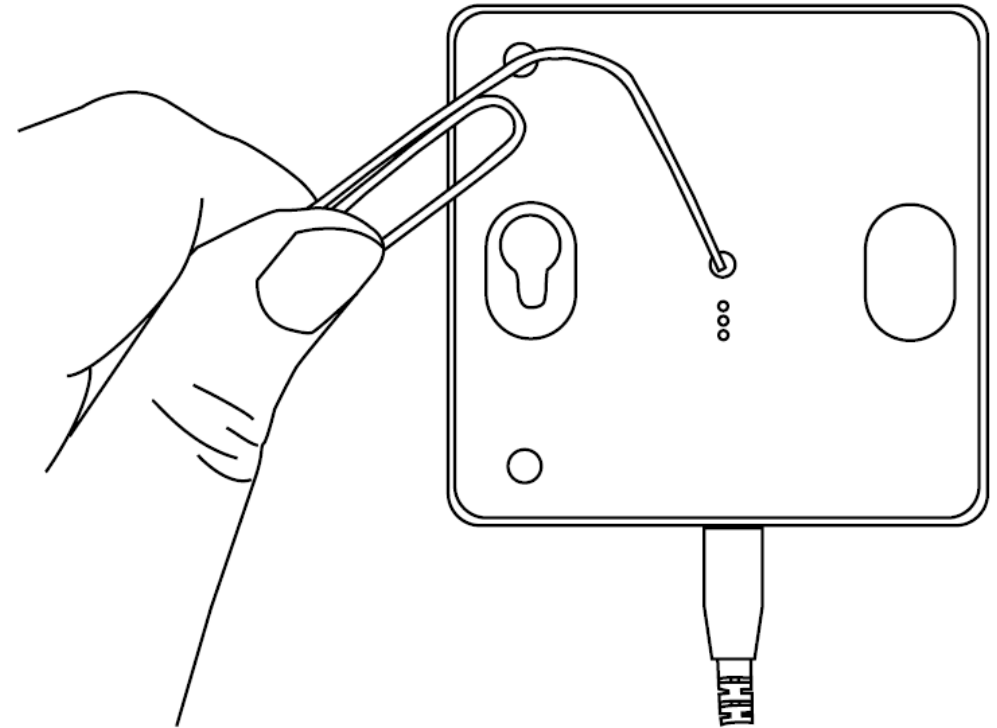

3A. Add Silent Trac to network

- You are in pairing mode while the LED is flashing blue. Pairing mode will time out in 5 minutes. When the LED turns red, pairing mode has ended.
- On each Silent Trac you want to pair to the bridge, pull the pendant down once to start the curtain, wait one second, then pull down once to stop the curtain.
- The green LED will flash, and the drapery will jog to confirm pairing.

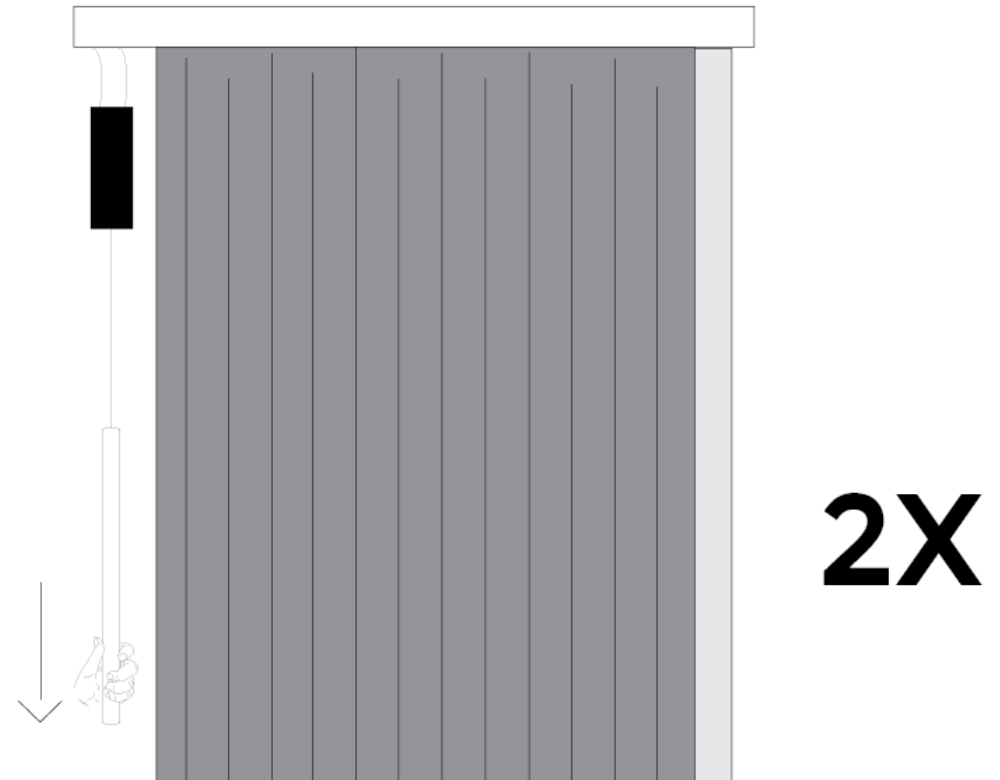

3B. Add remote to network

- Be sure you are still in pairing mode. If needed, restart pairing mode by pressing and holding the back button on the bridge until the LEDs flash blue.
- While in pairing mode, pull the “pull” tab from the bottom of the remote, or press and release a button. The LEDs on the front of the remote will scroll to show it searching for a network.
- When the LEDs flash, the network has been found and the remote is connected.
- If the remote does not find a network, the LEDs will turn off after 10 seconds.

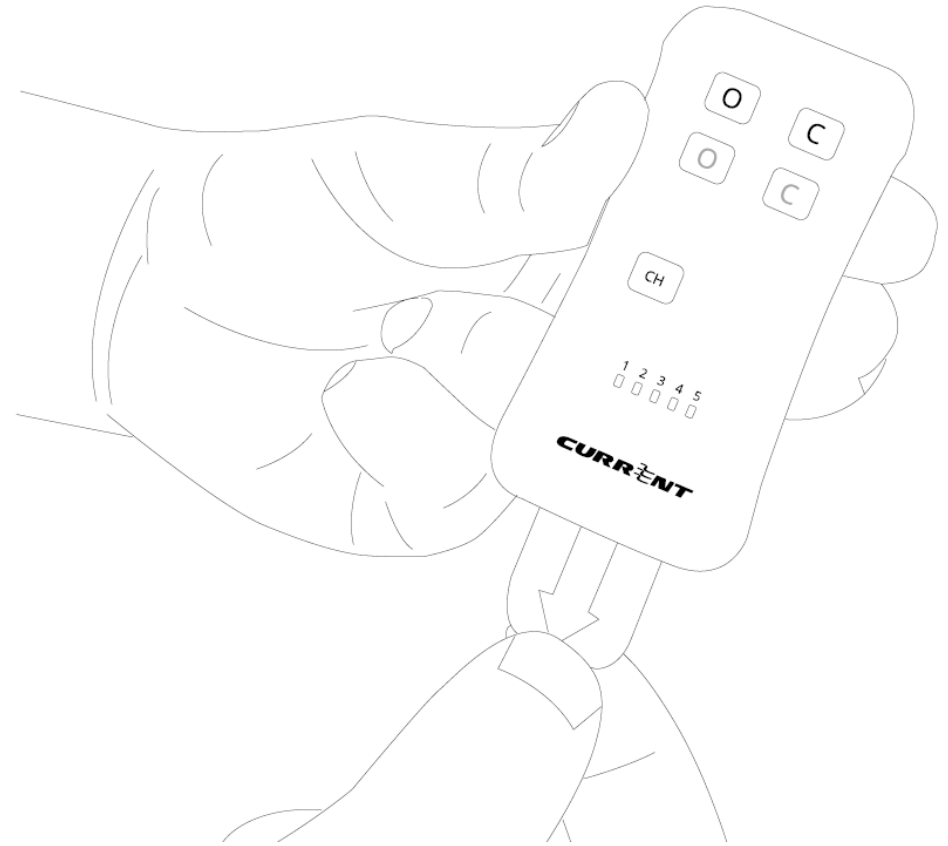

4A. Pair remote to Silent Trac

- Put the Silent Trac into pairing mode.
 - Pull down and release the pendant once to start the curtain, wait one second, then pull down and release the pendant again to stop the curtain.

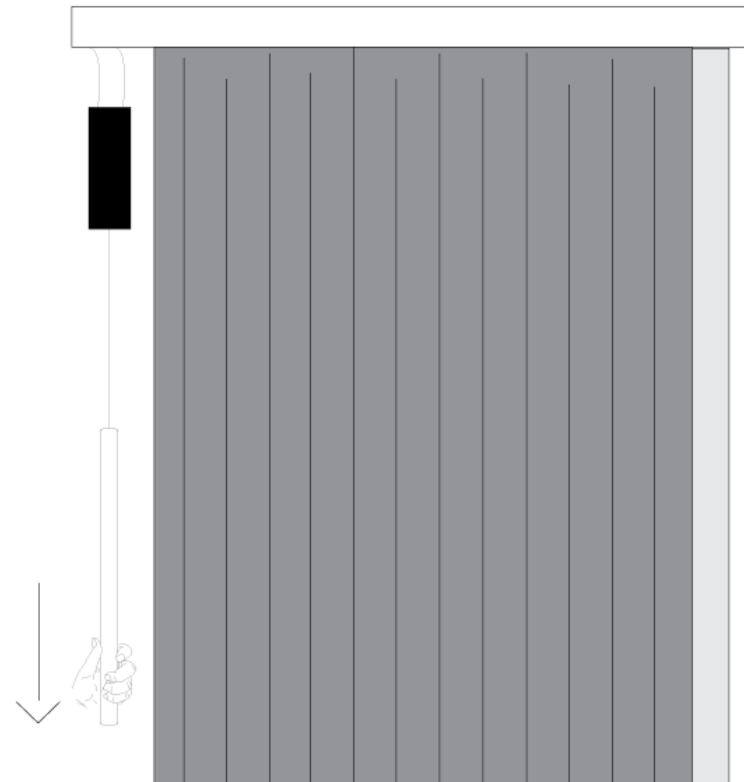

2X

4A. Pair remote to Silent Trac

- Pair remote to Silent Trac
 - Select the channel by pressing and releasing the channel button until the corresponding LED lights up.
 - Use a tack or pen to press and release the button in the hole on the back of the remote. The LEDs on the front of the remote will scroll.
 - Press and release the top left button on the remote. The curtain will jog to confirm it has been paired.

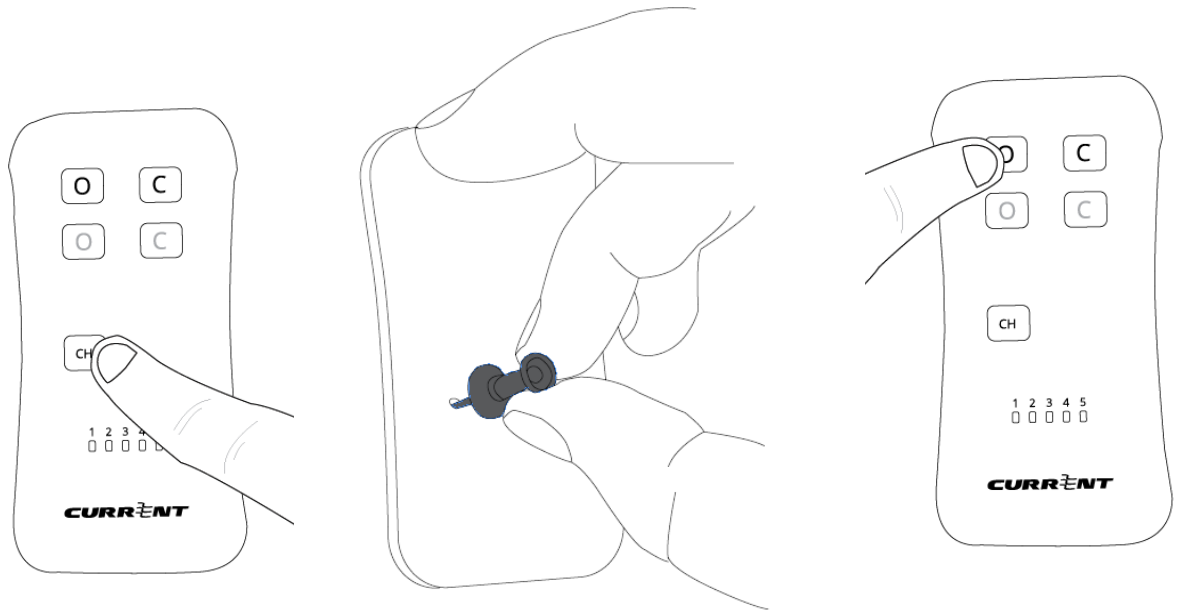

CURRENT